



NOTICE OF MEETING

Special Licensing Sub Committee

TUESDAY, 5TH APRIL, 2011 at 19:00 HRS - CIVIC CENTRE, HIGH ROAD, WOOD GREEN, N22 8LE.

MEMBERS: Councillors Brabazon, Browne and Strang

AGENDA

1. **ELECTION OF CHAIR**
2. **APOLOGIES FOR ABSENCE**
3. **URGENT BUSINESS**

It being a special meeting of the Sub Committee, under Part Four, Section B, Paragraph 17, of the Council's Constitution, no other business shall be considered at the meeting.

4. **DECLARATIONS OF INTEREST**

A member with a personal interest in a matter who attends a meeting of the authority at which the matter is considered must disclose to that meeting the existence and nature of that interest at the commencement of that consideration, or when the interest becomes apparent.

A member with a personal interest in a matter also has a prejudicial interest in that matter if the interest is one which a member of the public with knowledge of the relevant facts would reasonably regard as so significant that it is likely to prejudice the member's judgement of the public interest **and** if this interest affects their financial position or the financial position of a person or body as described in paragraph 8 of the Code of Conduct **and/or** if it relates to the determining of any approval, consent, licence, permission or registration in relation to them or any person or body described in paragraph 8 of the Code of Conduct.

5. SUMMARY OF PROCEDURE (PAGES 1 - 2)

The Chair will explain the procedure that the Committee will follow for the hearing considered under the Licensing Act 2003. A copy of the procedure is attached.

6. THE BLUE BAR, 675 HIGH ROAD, TOTTENHAM, LONDON N17 8AD (PAGES 3 - 90)

To consider an application to allow the Provision of Regulated Entertainment, The Provision of Late Night Refreshment and Supply of Alcohol at the premises.

Please note that, it being a special meeting of the Sub Committee, under Part Four, Section B, Paragraph 17, of the Council's Constitution, no other business shall be considered at the meeting.

Ken Pryor
Deputy Head of Local Democracy and Member
Services
5th Floor
River Park House
225 High Road
Wood Green
London N22 8HQ

Helen Chapman
Principal Committee Coordinator
(Non Cabinet Committees)
Tel: 020-8489 2615
Fax: 020-8489 2660
Email: helen.chapman@haringey.gov.uk

Monday, 28 March 2011

LICENSING SUB-COMMITTEE HEARINGS PROCEDURE SUMMARY	
INTRODUCTION	
1.	The Chair introduces himself and invites other Members, Council officers, Police, Applicant and Objectors to do the same.
2.	The Chair invites Members to disclose any prior contacts (before the hearing) with the parties or representations received by them
3.	The Chair explains the procedure to be followed by reference to this summary which will be distributed.
NON-ATTENDANCE BY PARTY OR PARTIES	
4.	If one or both of the parties fails to attend, the Chair decides whether to:
	(i) grant an adjournment to another date, or
	(ii) proceed in the absence of the non-attending party.
	Normally, an absent party will be given one further chance to attend.
TOPIC HEADINGS	
5.	The Chair suggests the “topic headings” for the hearing. In the case of the majority of applications for variation of hours, or other terms and conditions, the main topic is:
	Whether the extensions of hours etc. applied for would conflict with the four licensing objectives i.e.
	(i) the prevention of crime and disorder,
	(ii) public safety,
	(iii) the prevention of public nuisance, and
	(iv) the protection of children from harm.
6.	The Chair invites comments from the parties on the suggested topic headings and decides whether to confirm or vary them.
WITNESSES	
7.	The Chair asks whether there are any requests by a party to call a witness and decides any such request.
8.	Only if a witness is to be called, the Chair then asks if there is a request by an opposing party to “cross-examine” the witness. The Chair then decides any such request.
DOCUMENTARY EVIDENCE	
9.	The Chair asks whether there are any requests by any party to introduce late documentary evidence.
10.	If so, the Chair will ask the other party if they object to the admission of the late documents.
11.	If the other party do object to the admission of documents which have only been produced by the first party at the hearing, then the documents shall not be admitted.

12.	If the other party object to documents produced late but before the hearing, the following criteria shall be taken into account when the Chair decides whether or not to admit the late documents:	
(i)	What is the reason for the documents being late?	
(ii)	Will the other party be unfairly taken by surprise by the late documents?	
(iii)	Will the party seeking to admit late documents be put at a major disadvantage if admission of the documents is refused?	
(iv)	Is the late evidence really important?	
(v)	Would it be better and fairer to adjourn to a later date?	
THE LICENSING OFFICER'S INTRODUCTION		
13.	The Licensing Officer introduces the report explaining, for example, the existing hours, the hours applied for and the comments of the other Council Services or outside official bodies. This should be as "neutral" as possible between the parties.	
14.	The Licensing Officer can be questioned by Members and then by the parties.	
THE HEARING		
15.	This takes the form of a discussion led by the Chair. The Chair can vary the order as appropriate but it should include:	
(i)	an introduction by the Objectors' main representative	
(ii)	an introduction by the Applicant or representative	
(iii)	questions put by Members to the Objectors	
(iv)	questions put by Members to the Applicant	
(v)	questions put by the Objectors to the Applicant	
(vi)	questions put by the Applicant to the Objectors	
CLOSING ADRESSES		
16.	The Chair asks each party how much time is needed for their closing address, if they need to make one.	
17.	Generally, the Objectors make their closing address before the Applicant who has the right to the final closing address.	
THE DECISION		
18.	Members retire with the Committee Clerk and legal representative to consider their decision including the imposition of conditions.	
19.	The decision is put in writing and read out in public by the Committee Clerk once Members have returned to the meeting.	

Licensing Act 2003 Sub-Committee on 5th April 2011

Report title: Application for a new Premises Licence at THE BLUE BAR, 675 HIGH ROAD, TOTTENHAM, LONDON N17 8AD

Report of: The Lead Officer Licensing

Ward(s) affected Northumberland Park

1. Purpose

To consider an application by Arben Neza to allow The Provision of Regulated Entertainment, The Provision of Late Night Refreshment and Supply of Alcohol at the premises.

2. Recommendations

- 2.1 (a) Grant the application as asked
 (b) Modify the conditions of the licence, by altering or omitting or adding to them
 (c) Reject the whole or part of the application

The Committee is asked to note that it may not modify the conditions or reject the whole or part of the application unless it is necessary to promote the licensing objectives.

Report authorised by: Robin Payne.....

 Head of Enforcement Services

Contact Officer: Ms Daliah Barrett -Williams

Telephone: 020 8489 8232

3. Executive summary

For consideration by Sub Committee under Licensing Act 2003 for a new Premises licence.

4. Access to information:

Local Government (Access to Information) Act 1985
 Background Papers

The following Background Papers are used in the preparation of this Report:

File: THE BLUE BAR

The Background Papers are located at Enforcement Service, Civic Centre, High Road Wood Green N22

This page is intentionally left blank

5. REPORT

Background

5.1 An application for a new Premises Licence, by Arben Neza in respect of The Blue Bar, 675 High Road, Tottenham, London N17 8AD under the Licensing Act 2003.

5.2 **Details of the application being sought under a new Premises Licence APP1**

The Provision of Regulated Entertainment: Live Music & Performance of Dance

Thursday	2000 to 0100 hours
Friday & Saturday	2000 to 0300 hours
Sunday	2000 to 0000 hours

Recorded Music

Sunday to Wednesday	0900 to 0100 hours
Thursday	0900 to 0200 hours
Friday & Saturday	0900 to 0300 hours

Provision Of Facilities For Making Music

Tuesday	2000 to 0100 hours
Thursday	2000 to 0100 hours
Friday to Sunday	2000 to 0300 hours

Provision of Facilities for Late Night Refreshment:

Sunday to Wednesday	2300 to 0030 hours
Thursday	2300 to 0130 hours
Friday & Saturday	2300 to 0230 hours

Supply of Alcohol:

Sunday	0800 to 0100 hours
Monday	0900 to 0030 hours
Tuesday & Wednesday	0830 to 0030 hours
Thursday	0830 to 0130 hours
Friday & Saturday	0800 to 0230 hours

Opening Hours:

Sunday to Wednesday	0800 to 0100 hours
Thursday	0800 to 0200 hours
Friday & Saturday	0800 to 0300 hours

General-all four licensing objectives

5.3 **Crime and Disorder**

CCTV cameras will be installed and maintained on the premises. Premises will collaborate with the Metropolitan Police.

5.4 Public Safety

A fire warning system will be in place.

5.5 Public Nuisance

The premises has been designed with nuisance prevention in mind.

Notices will be displayed requesting that customers leave the premises quietly.

5.6 Child Protection

Children must be accompanied by an adult.

6. RELEVANT REPRESENTATIONS (CONSULTATION)

Responsible authorities:

6.1 Comments of Metropolitan Police

Have made representation which has now been withdrawn. **APP 2**

6.2 Comments of Enforcement Services:

Noise Team

Have made representation which has now been agreed. **APP 3**

Food Team

Have no objections to this application.

Health and Safety

Have no objections to this application

Trading Standards

Have no objections to this application

Building Control

Have commented on the application.

6.3 Fire Officer

Have no objections to this application

6.4 Planning Officer

Have commented on the application. **APP 4**

6.5 Comments of Child Protection Agency or Nominee

Have no objections to this application

7.0 Interested Parties

Letters of representation have been received against this application: 2 letters have been received from Ashleigh Trezise, a standard letter has been circulated by residents to other residents of which 11 have signed and 2 additional letters have been received, one from Cllr Peacock. **APP 5**

We have received written response from Mr Neza to the letter from Ms Trezise. This is attached at Appendix 6.

8.0 Financial Comments

The fee which would be applicable for this application was **£190.00**

9.0 Licensing Officers Comments

The Blue Bar was originally granted a licence in 2005 under Mr Neza and traded as Bar Harmonia under him.

Mr Neza is the leaseholder of the property, in 2007 Mr Neza sub let the property to Omar Wadar, (the licence was transferred to Mr Wadar in September 2007), who became the premises licence holder. Mr Neza remained on the licence for a short period of time as the DPS to permit the sale of alcohol at the premises. Mr Wadar had a number of problems at the premises which stemmed from cultural differences within the Somalian Community which the business catered for. Mr Wadar also applied to vary the licence to remove the ability for the sale of alcohol.

It is fair to say that Mr Wadar had problems at the premises and there were incidents of disorder from the premises at the time.

In 2009 Mr Wadar varied the licence to add sale of alcohol back onto the licence, he then further leased the premises on to Mr and Mrs Kabeya, (they transferred the premises licence into their name in Jan 2010) who operated the premises in a manner that led to the police reviewing the premises licence in September 2010.

The licensing sub committee saw CCTV footage of fights taking place outside the premises and also evidence of the premises being operated beyond its permitted licensable times. The Sub Committee revoked the licence from Mr & Mrs Kabeya in October 2010. Mrs and Mrs Kabeya tried to get a family member to re-apply for the licence but this was blocked by Mr Neza, who took steps to secure the building and stop any further use by that party.

Mr Neza still has an interest in the property as he is still the leaseholder, but due to the Premises licence being revoked while under the management of Mr and Mrs Kabeya, it has now become necessary for him to re-apply for a premises licence.

Members may wish to consider if the conditions offered by Mr Neza are adequate for the licensable activities and the hours being requested. I have attached a copy of the previous revoked licence. Appendix 7.

APPENDIX 1

APPLICATION

LICENSING ACT 2003
Section 17

AG 985560

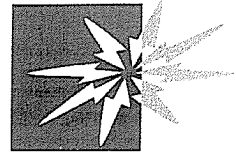

Haringey Council

Application for a premises licence to be granted under the Licensing Act 2003

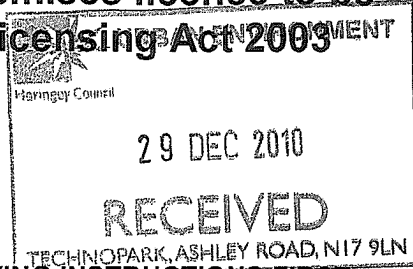

Reference number:

(1)

PLEASE READ THE FOLLOWING INSTRUCTIONS FIRST

Before completing this form please read the guidance notes at the end of the form. If you are completing this form by hand please write legibly in block capitals. In all cases ensure that your answers are inside the boxes and written in black ink. Use additional sheets if necessary. You may wish to keep a copy of the completed form for your records

(2) I/We **ARBEN NEZA**

apply for a premises licence under section 17 the Licensing Act 2003 for the premises described in Part 1 below (the premises) and I/we are making this application to you as the relevant licensing authority in accordance with section 12 of the Licensing Act 2003

Part 1 - Premises details

Postal address of premises or, if none, Ordnance Survey map reference or description "THE BLUE BAR" 675 HIGH ROAD TOTTENHAM	
Post town LONDON	Postcode N17 8AD

Telephone number at premises(if any) **0208 885 0500**

Non-domestic rateable value of premises £

Part 2 - Applicant details

Please state whether you are applying for a premises licence as

Please tick yes

- a) an individual or individuals* please complete section (A)
- b) a person other than an individual*
 - i. as a limited company please complete section (B)
 - ii. as a partnership please complete section (B)
 - iii. as an unincorporated association; or please complete section (B)
 - iv. other (for example a statutory corporation) please complete section (B)

(1) Insert name and address of relevant licensing authority and its reference number (optional)
(2) Insert name(s) of applicant

- c) a recognised club please complete section (B)
- d) a charity please complete section (B)
- e) the proprietor of an educational establishment please complete section (B)
- f) a health service body please complete section (B)
- g) a person who is registered under Part 2 of the Care Standards Act 2000 (c14) in respect of an independent hospital please complete section (B)
- h) the chief officer of police of a police force in England and Wales please complete section (B)

* If you are applying as a person described in (a) or (b) please confirm:

- I am carrying on or proposing to carry on a business which involves the use of the premises for licensable activities; or Please tick yes
- I am making the application pursuant to
 - a statutory function; or
 - a function discharged by virtue of Her Majesty's prerogative

(A) INDIVIDUAL APPLICANTS (fill in as applicable)

Mr Mrs Miss Ms Other title (for example, Rev)

Surname First names

I am 18 years old or over Please tick yes Date of birth

Day	Month	Year
06	12	1975

Current postal address if different from premises address

Post town Postcode

Daytime contact telephone number

E-mail address (optional)

SECOND INDIVIDUAL APPLICANT (if applicable)

Mr Mrs Miss Ms Other title
 (for example, Rev)

Surname First names

I am 18 years old or over Please tick yes
 Date of birth Day Month Year

Current postal address if different from premises address

Post town Postcode

Daytime contact telephone number

E-mail address (optional)

(B) OTHER APPLICANTS

Please provide name and registered address of applicant in full. Where appropriate please give any registered number. In the case of a partnership or other joint venture (other than a body corporate), please give the name and address of each party concerned.

Name
Address
Registered number (where applicable)
Description of applicant (for example partnership, company, unincorporated association etc.)
Telephone number (if any)
E-mail address (optional)

Part 3 - Operating Schedule

When do you want the premises licences to start?

Day	Month	Year
16	01	2011

If you wish the licence to be valid only for a limited period, when do you want it to end?

Day	Month	Year

Please give a general description of the premises (please read guidance note 1)

MY PLACE IS LOCATED IN THE MAIN ROAD OF THE TOTTENHAM ~~IS~~ THIS PREMISES IS VERY CONECT WITH THE LOCAL PEOPLE AND FOOTBALL FANS.

~~HOWEVER~~ HOWEVER THE LICENCE I AM ASKING FOR I WILL USE AND BRING THE COMMUNITY THAT WHICH THEY MISSED SINCE LAST TIME I WAS OPERATING "THE BLUE BAR" MY SELF.

I PROMISE THAT "THE BLUE BAR" AND HIS MANAGEMENT WILL BRING GOOD CROWD AND NICE ATMOSPHERE

If 5,000 or more people are expected to attend the premises at any one time, please state the number expected to attend

--

What licensable activities do you intend to carry on from the premises?
 (Please see sections 1 and 14 of the Licensing Act 2003 and Schedule 1 and 2 to the Licensing Act 2003)

Provision of regulated entertainment

- | | |
|--|---|
| | Please tick <input checked="" type="checkbox"/> yes |
| a) plays (if ticking yes, fill in box A) | <input type="checkbox"/> |
| b) films (if ticking yes, fill in box B) | <input type="checkbox"/> |
| c) indoor sporting events (if ticking yes, fill in box C) | <input type="checkbox"/> |
| d) boxing or wrestling entertainment (if ticking yes, fill in box D) | <input type="checkbox"/> |
| e) live music (if ticking yes, fill in box E) | <input checked="" type="checkbox"/> |
| f) recorded music (if ticking yes, fill in box F) | <input checked="" type="checkbox"/> |
| g) performances of dance (if ticking yes, fill in box G) | <input checked="" type="checkbox"/> |
| h) anything of a similar description to that falling within (e), (f) or (g)
(if ticking yes, fill in box H) | <input type="checkbox"/> |

Provision of entertainment facilities for:

- | | |
|--|-------------------------------------|
| i) making music (if ticking yes, fill in box I) | <input checked="" type="checkbox"/> |
| j) dancing (if ticking yes, fill in box J) | <input checked="" type="checkbox"/> |
| k) entertainment of a similar description to that falling within (i) or (j)
(if ticking yes, fill in box K) | <input type="checkbox"/> |

Provision of late night refreshment (if ticking yes, fill in box L)

Supply of alcohol (if ticking yes, fill in box M)

In all cases complete boxes N, O and P

A

Plays			Will the performance of a play take place indoors or outdoors or both - please tick <input checked="" type="checkbox"/> (please read guidance note 2) Indoors <input type="checkbox"/> Outdoors <input type="checkbox"/> Both <input type="checkbox"/>	
Standard days and timings (please read guidance note 6)				
Day	Start	Finish	Please give further details here (please read guidance note 3)	
Mon				
Tue				
Wed				State any seasonal variations for performing plays (please read guidance note 4)
Thur				
Fri				Non-standard timings. Where you intend to use the premises for the performance of plays at different times from those listed in the column on the left, please list (please read guidance note 5)
Sat				
Sun				

B

Films			Will the exhibition of films take place indoors or outdoors or both - please tick <input checked="" type="checkbox"/> (please read guidance note 2) Indoors <input type="checkbox"/> Outdoors <input type="checkbox"/> Both <input type="checkbox"/>	
Standard days and timings (please read guidance note 6)				
Day	Start	Finish	Please give further details here (please read guidance note 3)	
Mon				
Tue				
Wed				State any seasonal variations for the exhibition of films (please read guidance note 4)
Thur				
Fri				Non-standard timings. Where you intend to use the premises for the exhibition of films at different times from those listed in the column on the left, please list (please read guidance note 5)
Sat				
Sun				

C

Indoor sporting events			Please give further details here (please read guidance note 3)
Standard days and timings (please read guidance note 6)			
Day	Start	Finish	
Mon			
Tue			State any seasonal variations for indoor sporting events (please read guidance note 4)
Wed			
Thur			Non-standard timings. Where you intend to use the premises for indoor sporting events at different times from those listed in the column on the left, please list (please read guidance note 5)
Fri			
Sat			
Sun			

D

Boxing or wrestling entertainments			Will the boxing or wrestling entertainment take place indoors or outdoors or both - please tick <input checked="" type="checkbox"/> (please read guidance note 2)
Standard days and timings (please read guidance note 6)			
Day	Start	Finish	Indoors <input type="checkbox"/> Outdoors <input type="checkbox"/> Both <input type="checkbox"/>
Mon			Please give further details here (please read guidance note 3)
Tue			
Wed			State any seasonal variations for boxing or wrestling entertainment (please read guidance note 4)
Thur			
Fri			Non-standard timings. Where you intend to use the premises for boxing or wrestling entertainment at different times from those listed in the column on the left, please list (please read guidance note 5)
Sat			
Sun			

E

Live music Standard days and timings (please read guidance note 6)			Will the performance of live music take place indoors or outdoors or both - please tick <input checked="" type="checkbox"/> (please read guidance note 2)
Day	Start	Finish	Indoors <input checked="" type="checkbox"/> Outdoors <input type="checkbox"/> Both <input type="checkbox"/>
Mon			Please give further details here (please read guidance note 3)
Tue			
Wed			State any seasonal variations for the performance of live music (please read guidance note 4)
Thur	20.00	01.00	
Fri	20.00	03.00	Non-standard timings. Where you intend to use the premises for the performance of live music at different times from those listed in the column on the left, please list (please read guidance note 5)
Sat	20.00	03.00	
Sun	20.00	00.00	

O C C A S S I O N A L Y

F

Recorded music Standard days and timings (please read guidance note 6)			Will the playing of recorded music take place indoors or outdoors or both - please tick <input checked="" type="checkbox"/> (please read guidance note 2)
Day	Start	Finish	Indoors <input checked="" type="checkbox"/> Outdoors <input type="checkbox"/> Both <input type="checkbox"/>
Mon	09.00	01.00	Please give further details here (please read guidance note 3)
Tue	09.00	01.00	
Wed	09.00	01.00	State any seasonal variations for the playing of recorded music (please read guidance note 4)
Thur	09.00	02.00	
Fri	09.00	03.00	Non-standard timings. Where you intend to use the premises for the playing of recorded music entertainment at different times from those listed in the column on the left, please list (please read guidance note 5)
Sat	09.00	03.00	
Sun	09.00	01.00	

G

Performances of dance Standard days and timings (please read guidance note 6)			Will the performance of dance take place indoors or outdoors or both - please tick <input checked="" type="checkbox"/> (please read guidance note 2)
Day	Start	Finish	Indoors <input checked="" type="checkbox"/> Outdoors <input type="checkbox"/> Both <input type="checkbox"/>
Mon			Please give further details here (please read guidance note 3)
Tue			State any seasonal variations for the performance of dance (please read guidance note 4)
Wed			Non-standard timings. Where you intend to use the premises for the performance of dance entertainment at different times from those listed in the column on the left, please list (please read guidance note 5)
Thur	20,00	01,00	
Fri	20,00	03,00	
Sat	20,00	03,00	
Sun	20,00	01,00	

H

Anything of a similar description to that falling within (e), (f) or (g) Standard days and timings (please read guidance note 6)			Please give a description of the type of entertainment you will be providing
Day	Start	Finish	Will this entertainment take place indoors or outdoors or both - please tick <input checked="" type="checkbox"/> (please read guidance note 2)
Mon			Indoors <input type="checkbox"/> Outdoors <input type="checkbox"/> Both <input type="checkbox"/>
Tue			Please give further details here (please read guidance note 3)
Wed			State any seasonal variations for entertainment of a similar description to that falling within (e), (f) or (g) (please read guidance note 4)
Thur			Non-standard timings. Where you intend to use the premises for the entertainment of similar description to that falling within (e), (f) or (g) at different times from those listed in the column on the left, please list (please read guidance note 5)
Fri			
Sat			
Sun			

Provision of facilities for making music			Please give a description of the facilities for making music you will be providing
Standard days and timings (please read guidance note 6)			
Day	Start	Finish	Will the facilities for making music be indoors or outdoors or both - please tick <input checked="" type="checkbox"/> (please read guidance note 2) Indoors <input type="checkbox"/> Outdoors <input type="checkbox"/> Both <input type="checkbox"/>
Mon			Please give further details here (please read guidance note 3)
Tue	20.00 20.00	04.00 01.00	
Wed			State any seasonal variations for the provision of facilities for making music (please read guidance note 4)
Thur	20.00	01.00	
Fri	20.00	03.00	Non-standard timings. Where you intend to use the premises for provision of facilities for making music at different times from those listed in the column on the left, please list (please read guidance note 5)
Sat	20.00	03.00	
Sun	21.00	03.00	

J

Provision of facilities for dancing			Please give a description of the facilities for dancing you will be providing
Standard days and timings (please read guidance note 6)			
Day	Start	Finish	Will the facilities for dancing be indoors or outdoors or both - please tick <input checked="" type="checkbox"/> (please read guidance note 2) Indoors <input type="checkbox"/> Outdoors <input type="checkbox"/> Both <input type="checkbox"/>
Mon			Please give further details here (please read guidance note 3)
Tue			
Wed			State any seasonal variations for providing dancing facilities (please read guidance note 4)
Thur			
Fri			Non-standard timings. Where you intend to use the premises for the provision of facilities for dancing entertainment at different times from those listed in the column of the left, please list (please read guidance note 5)
Sat			
Sun			

K

Provision of facilities for entertainment of a similar description to that falling within I or J			Please give a description of the type of entertainment facility you will be providing
Standard days and timings (please read guidance note 6)			Will the entertainment facility be indoors or outdoors or both - please tick <input checked="" type="checkbox"/> (please read guidance note 2)
Day	Start	Finish	Indoors <input type="checkbox"/> Outdoors <input type="checkbox"/> Both <input type="checkbox"/>
Mon			Please give further details here (please read guidance note 3)
Tue			State any seasonal variations for the provision of facilities for entertainment of a similar description to that falling within I or J (please read guidance note 4)
Wed			Non-standard timings. Where you intend to use the premises for the provision of facilities for entertainment of a similar description to that falling within I or J at different times from those listed in the column on the left, please list (please read guidance note 5)
Thur			
Fri			
Sat			
Sun			

L

Late night refreshment			Will the provision of late night refreshment take place indoors or outdoors or both - please tick <input checked="" type="checkbox"/> (please read guidance note 2)
Standard days and timings (please read guidance note 6)			
Day	Start	Finish	Indoors <input checked="" type="checkbox"/> Outdoors <input type="checkbox"/> Both <input type="checkbox"/>
Mon	23.00	00.30	Please give further details here (please read guidance note 3)
Tue	23.00	00.30	
Wed	23.00	00.30	State any seasonal variations for the provision of late night refreshment (please read guidance note 4)
Thur	23.00	00.30	
Fri	23.00	02.30	Non-standard timings. Where you intend to use the premises for the provision of late night refreshment at different times from those listed in the column on the left, please list (please read guidance note 5)
Sat	23.00	02.30	
Sun	23.00	00.30	

M

Supply of alcohol			Will the sale of alcohol be for consumption - please tick box <input checked="" type="checkbox"/> (please read guidance note 7)
Standard days and timings (please read guidance note 6)			
Day	Start	Finish	On the premises <input checked="" type="checkbox"/> Off the premises <input type="checkbox"/> Both <input type="checkbox"/>
Mon	09.00	00.30	State any seasonal variations for the supply of alcohol (please read guidance note 4)
Tue	08.30	00.30	
Wed	08.30	00.30	
Thur	08.30	02.30	Non-standard timings. Where you intend to use the premises for the supply of alcohol at different times from those listed in the column on the left, please list (please read guidance note 5)
Fri	08.30	02.30	
Sat	08.00	02.30	
Sun	08.00	01.00	

State the name and details of the individual whom you wish to specify on the licence as premises supervisor

Name ARBEN NEZA
 Address 319 BOWES ROAD
 NEW SOUTHBATE LONDON
 Postcode N11 1BA
 Personal Licence number (if known) LN/200600175
 Issuing licensing authority (if known) LONDON BOROUGH OF ENFIELD

N

Please highlight any adult entertainment or services, activities, other entertainment or matters ancillary to the use of the premises that may give rise to concern in respect of children (please read guidance note 8)

CHILDREN WILL BE WELCOME WITH ADULT ACCOMPANIED BECAUSE WE ARE HAVING A ALCOHOL SERVED HOWEVER MY STAFF WILL BE VERY HELPFUL TO EXPLAIN AND HELP ANY CUSTOMERS INCLUDE CHILDREN.

O

Hours premises are open to the public

Standard days and timings (please read guidance note 6)

Day	Start	Finish
Mon	08.00	01.00
Tue	08.00	01.00
Wed	08.00	01.00
Thur	08.00	02.00
Fri	09.00	03.00
Sat	08.00	03.00
Sun	08.00	01.00

State any seasonal variations (please read guidance note 4)

Non-standard timings. Where you intend to use the premises to be open to the public at different times from those listed in the column on the left, please list (please read guidance note 5)

P Describe the steps you intend to take to promote the four licensing objectives:

a) General - all four licensing objectives (b, c, d, e) (please read guidance note 9)

ADVERTISE MY APPLICATION TO THE
RIGHT PLACE WHERE PUBLIC CAN
BE INFORMED

b) The prevention of crime and disorder

MAKING CCTV CAMERA ~~AND~~ SYSTEM
AND COLLABORATION WITH THE MET POLICE

c) Public safety

THE INDICATIONS FOR ANY DANGER
SUCH FIRE ETC. AND WARNING THEM
FOR ANYTHING

d) The prevention of public nuisance

THE PLACE HAS BEING BUILT FROM
INSIDE WITH ALL THE NON NUISANCE
MATERIALS AND STRUCTURES.
MAKING SURE WHEN MY CUSTOMER
LEAVE THE PREMISES THEY WILL BE INFORMED
TOO

e) The protection of children from harm

THE CHILDREN ARE A PRIORITY AND
WELCOME IN MY PREMISES AND
ACCOMPANIED WITH AN ADULT.

CHECKLIST:

Please tick ✓

- I have made or enclosed payment of the fee
- I have enclosed the plan of the premises
- I have sent copies of this application and the plan to responsible authorities and others where applicable
- I have enclosed the consent form completed by the individual I wish to be premises supervisor, if applicable
- I understand that I must now advertise my application
- I understand that if I do not comply with the above requirements my application will be rejected

IT IS AN OFFENCE, LIABLE ON CONVICTION TO A FINE UP TO LEVEL 5 ON THE STANDARD SCALE, UNDER SECTION 158 OF THE LICENSING ACT 2003 TO MAKE A FALSE STATEMENT IN OR IN CONNECTION WITH THIS APPLICATION

Part 4 - Signatures (please read guidance note 10)

Signature of applicant or applicant's solicitor or other duly authorised agent. (Please read guidance note 11)
If signing on behalf of the applicant please state in what capacity.

Signature *[Handwritten Signature]*

Date 29/12/2010

Capacity

For joint applications signature of 2nd applicant, 2nd applicant's solicitor or other authorised agent.
(Please read guidance note 12)

If signing on behalf of the applicant please state in what capacity.

Signature _____

Date

Capacity

Contact name (where not previously given) and postal address for correspondence associated with this application (please read guidance note 13)	
Post town	Postcode
Telephone number (if any)	
If you would prefer us to correspond with you by e-mail your e-mail address (optional)	

Notes for Guidance

1. Describe the premises. For example the type of premises, its general situation and layout and any other information which could be relevant to the licensing objectives. Where your application includes off-supplies of alcohol and you intend to provide a place for consumption of these off-supplies you must include a description of where the place will be and its proximity to the premises.
2. Where taking place in a building or other structure please tick as appropriate. Indoors may include a tent.
3. For example the type of activity to be authorised, if not already stated, and give relevant further details, for example (but not exclusively) whether or not music will be amplified or unamplified.
4. For example (but not exclusively), where the activity will occur on additional days during the summer months.
5. For example (but not exclusively), where you wish the activity to go on longer on a particular day e.g. Christmas Eve.
6. Please give timings in 24 hour clock (e.g. 16:00) and only give details for the days of the week when you intend the premises to be used for the activity.
7. If you wish people to be able to consume alcohol on the premises please tick 'on the premises', if you wish people to be able to purchase alcohol to consume away from the premises please tick 'off the premises'. If you wish people to be able to do both please tick 'both'.
8. Please give information about anything intended to occur at the premises or ancillary to the use of the premises which may give rise to concern in respect of children, regardless of whether you intend children to have access to the premises, for example (but not exclusively) nudity or semi-nudity, films for restricted age groups, the presence of gaming machines.
9. Please list here steps you will take to promote all four licensing objectives together.
10. The application form must be signed.
11. An applicant's agent (for example solicitor) may sign the form on their behalf provided that they have actual authority to do so.
12. Where there is more than one applicant, both applicants or their respective agents must sign the application form.
13. This is the address which we shall use to correspond with you about this application.
14. The information you have provided will be held by the Council on computerised and manual files. The data may also be disclosed to other departments within the Council or other organisations, but only in order to ensure compliance with relevant legislation or to detect and prevent fraud or a crime.

APPENDIX 2

REPRESENTATION FROM
METROPOLITAN POLICE, NOW
WITHDRAWN



Your reference:

Our reference: 284/2010

Date: 5 January, 2011

Metropolitan Police Service

Ms D.BARRETT
ENVIRONMENTAL CONTROL SERVICES
TECHNO PARK
ASHLEY ROAD
TOTTENHAM N.17

Licensing
Quicksilver Patrol Base
Western Road
Wood Green
N.22 6UH

Tel: 0203 – 276 -0150

Dear Ms. Barrett

Re:- Application for a Premises Licence:-

Blue Bar, 675 High Road N.17

With reference to the above Police wish to make representations under the Prevention of Crime & Disorder, Prevention of Public Nuisance and Protection of Children from Harm Objectives.

Prevention of Crime & Disorder:-

A full digital C.C.T.V. system to be installed capable of taking head and shoulder images of people entering the premises and the images to be kept for 30 days and made available to Police on request. The cameras should also be positioned to cover inside and outside of the premises. The system should be operating whilst the premises are open to the public. Members of the management of the premises to be trained in the downloading of the images.

The system should be installed to the following standards:-

1. Guidance is contained in the C.C.T.V. Operational requirements Manual published by the Home Office Scientific Branch. Publication N0 28/09.
2. The system should be certified to European Standard BS EN 50132 - 7
3. The design and installation must be carried out by a NACOSS accredited company.

A minimum of 2 door staff who are Security Industry Authority registered to be employed on the premises on Thursday/Friday/Saturday and Sunday nights from 21.00 to close. The door staff will monitor the entry and exit of customers to prevent any disorder taking place and also search for drugs and weapons.

On Tottenham Hotspur Football Club match days.

1. Premises not to open for the sale of alcohol before 11.00 on Saturday and Sunday.
2. All drinks dispensed from the bar are poured into plastic containers - 4 hours before the scheduled kick off time until 1 hour after the end of the match.
3. No glass bottles are sold over the bar - 4 hours before the scheduled kick off time until 1 hour after the end of the match.
4. A Minimum of two Door Staff who have been approved by the Security Industry Authority to be employed on the premises to control the entry and exit of customers - 4 hours before the schedule kick off time until 1 hour after the end of the match.

Prevention of Public Nuisance.

A notice to be displayed prominently at the exit asking customers to leave quietly.

Customers exiting the premises to smoke to be restricted to no more than 3 at a time.

Protection of Children from Harm:-

Alcohol may only be sold to individuals over the age of 18 with valid proof of identification with one of the following:-

1. A valid passport
2. A photo driving licence issued in a European Country
3. A proof of age standard card system
4. A citizen card supported by the Home Office.

Unaccompanied children will not be allowed on the premises at any time.

I submit these representations on behalf of the Metropolitan Police.

Yours Sincerely

Geoffrey Parker
Licensing
Quicksilver Patrol Base

c.c. A.Neza

Olson Kendra

From: Arben Neza [thebluebar675@gmail.com]
Sent: 25 February 2011 14:42
To: Olson Kendra
Subject: Re: Representations from Responsible Authorities on the Blue Bar
Follow Up Flag: Follow up
Flag Status: Red

Hi Kendra

I am writing regarding the representation made by the Met Police about the needs to prevent order and noises on my premises.

I do agree with them and i will look forwards to apply with any equipments i am ask to do and complete my task as i being told.

The place will be safe and order with all the EU standards and UK regulations.

For any other informations you can contact me.

Many thanks

Arben Neza

The Blue Bar 675 High Road London N17 8AD

This email has been scanned by the MessageLabs Email Security System.
For more information please visit <http://www.messagelabs.com/email>



Your
reference:

Our reference: 284/2010

Date: 28 February, 2011

Metropolitan Police Service

Ms D.BARRETT
Licensing
Techno Park
Ashley Road
Tottenham N.17

Licensing
Quicksilver Patrol Base
Western Road
Wood Green
N.22 6UH

Tel: 0203 – 276 - 0150

Dear Ms. Barrett

Re:- Application for a Premises Licence:-

Blue Bar, 675 High Road N.17

With reference to the above application and our letter of representation dated the 31st of December 2010. I have received correspondence from the applicant agreeing to my representation.

I therefore wish to withdraw my representation.

If you require further information please do not hesitate to contact me on the above telephone number.

Yours Sincerely

Geoffrey Parker
Licensing
Quicksilver Patrol Base

c.c A.Neza

APPENDIX 3

REPRESENTATION FROM ENFORCEMENT RESPONSE

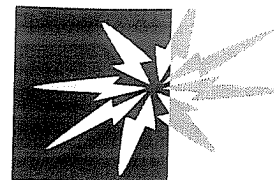

Haringey Council

Licensing Consultation - Internal Memo

To: Daliah Barrett-Williams

From: George Roberts (Noise)

Name of Officer preparing representation: George Roberts

cc: Team Leader Enforcement Response, Derek Pearce

Our Reference: WK/000179786

Date: 21st January 2011

Premises: The Blue Bar, 675 High Road, Tottenham, London, N17 8AD

Type of application: New

I would like to confirm that I have considered the above proposal with regard to the prevention of public nuisance on behalf of the Enforcement Response (Noise) Team & would like to make representations to the Application

The operating schedule does not address the prevention of public nuisance from:

- airborne entertainment noise
- Structure borne noise or vibrations from entertainment
- Noise generated by patrons in external areas of the premises
- Noise generated from patrons queuing to enter
- Noise from patrons exiting the premises
- Noise generated from deliveries
- Noise generated from refuse collections
- Noise from plant and machinery
- Light nuisance
- Cooking odour

The proposed operating hours are inappropriate due to the close proximity of residential dwellings.

Supporting Information



Date reported & time	Subject	Observations & time	Outcome	Our Ref
9/8/07 @0241 hrs	Loud Music	@0341 hrs Loud music witnessed from 40 yds away from bar and from complainants flat – Completed by MXE	Warning Letter issued + Licensing informed as premises open past licensed hrs	WK42640
26/8/07 @0353 hrs	Loud Music	Bar still open people seen going in. Loud music heard from inside - Completed by MXE	Report made to Licensing	WK46094
31/8/07 N/A	Pro-Active Visit	@0030 hrs Spoke to proprietor at length regarding license times and issue of unlicensed activity – Completed by BXO	N/A	WK45646
2/9/07 N/A	Pro-Active Visit	On arrival premises were still open for business, and loud music emanating from front of the building – door staff still on the external doors. At 0400 hrs people began to leave the premises. Spoke to Manager (Mr Kalniyn) who said he thought they had a licence until 0400 hrs – Completed by MXE	Report made to Licensing	WK45521
16/9/07 N/A	Pro-Active Visit	Smoking witnessed in rear enclosed area of premises and “oriental style” equipment being moved around – Completed by DCP	Report made to Smoke free Co-ordinator – Confirmed premises have compliant shisha smoking area for 8 persons which has no roof	WK47508
13/10/08 @0144 hrs	Loud music + Shouting	@0220 hrs Loud (African style) music heard in complainant’s bedroom at a volume which was keeping them awake and preventing them from sleeping – Music was very bassy. @0235 hrs I spoke to manager of bar and requested he reduce volume of music – Completed by GYR	Warning Letter issued	WK48338
26/3/09 N/A	Pro-Active Visit – Tailgate #29	Smoke free signage not adequate – Completed by CZG	FPN issued & paid	WK116084
10/5/09 @0155 hrs	Loud music	@0205 hrs Attended comps, slight bass music heard coming from across road from The Blue Bar. Attended Blue Bar, spoke to SIA on door, advised re levels of bass, bass turned down – Completed by CYB	Nuisance not established	WK119279 (1)

1/11/09 @0250 hrs	Loud music	@0415 hrs In the street I could hear bass from music coming from Blue Bar. Inside Comps flat music was very very faint and was below volume of fan/extract in Comps bedroom and not loud enough to warrant any formal action. I agreed to speak to manager of Blue Bar. I then spoke to venue management and showed him situation in Ruskin Rd - also discussed issue of alleyway with rubbish and toilet use – Completed by GYR	Nuisance not established	WK119279 (2)
6/6/10 @2118 hrs	Loud music & voices at rear in alleyway	@2200 hrs Abated, licensing offences. 2 x Licensing offences witnessed: 1) sale of alcohol outside of permitted conditions under the current licence – permitting patrons to consume outside the premises 2) Played loud music outside of premises at rear in contravention of licensing conditions Completed by CYB	Licensing Warning Letter issued.	WK158738 (2) + WK159113
6/6/10 @2248 hrs	Loud music	@2309 hrs noise off when call back made – Completed by MXE	N/A	WK158738 (1)
13/6/10 @2223 hrs	Loud music	@2300 hrs Music stopped prior to attending – Completed by CYB	Nuisance not established	WK158738 (3)
10/7/10 @1922 hrs	People noise	@1939 hrs Noise stopped – Completed by GYR	N/A	WK166463
11/7/10 @0600 hrs	Loud music	@0615 Noise stopped – Completed by CYB.	N/A	WK158738 (5)
12/7/10 @0202 hrs	Loud music & voices	@0242 hrs Some music audible from the front on the premises, unable to ascertain as a nuisance though. I spoke to the licensee and advised her to turn music down – Completed by MXE	Nuisance not established	WK158738 (4)
6/9/10 @ 1014 hrs	Wheelie bins left in rear alley way and are constantly overflowing and not being collected.	Visited site and found bins and also some dumped rubbish in the alley. (mattress, white doors etc) I intend to issue FPN to the operators of the Blue Bar 675 High Rd N17 for non compliance to the litter clearance notice previously served on them.	FPN Issued on 17/9/10 – Payment due.	WK169369 WK167874 WK171210

		Completed by WOW		
3/10/10 N/A	Premises Licence Review requested by Enforcement Response Team	<p>The Committee carefully considered the application for a review by the Metropolitan Police and heard from the licensee, took into careful account Haringey's licensing policy and amended guidance issued under section 182 of the Licensing Act 2003 and it was the Committee's decision to revoke the licence for the following reasons: -</p> <p>The failure of the Licensee to adhere to a number of the terms and conditions on their licence - amongst them: -</p> <ul style="list-style-type: none"> - Operating licensable activities outside of the licensed hours. - Failure to report incidents of a criminal nature to the Police. - Failure to co-operate with the Police in compliance with the conditions on their licence. - Failure to hire appropriately qualified door staff who are SIA registered. - Failure to hire an adequate number of door staff. - Failure to control the dispersal of patrons from the premises. - Failure to comply with the conditions on their licence in relation to CCTV provision. - Failure to take adequate 	Licence Revoked by Licensing Sub-Committee on 8/10/10	WK171954

		measures to prevent the premises from causing a public nuisance. In addition, the Committee was concerned that Mrs Kabeya appeared to have no clear understanding of her obligations as either a licensee or a designated premises supervisor.		
31/10/10 @0211 hrs	Loud music	@0330 hrs Premises being used without license	Simple Caution offered – Still to be resolved.	WK158738 (6) + WK175783

If the sub-committee were to grant this application then we would recommend the following alterations/conditions to the operating schedule:

Prevention of nuisance from noise / vibration

All doors and windows will remain closed during the licensed regulated entertainment activities or in any event after 11pm. The entrance door will be fitted with a self-closing device and staff required to ensure that it is not propped open. A member of staff shall be made responsible to ensure the door is opened for as brief a period as possible. Where necessary adequate and suitable mechanical ventilation should be provided to public areas

Entry to the premises will be restricted to main entrance located on High Road whilst the premises is being used for regulated entertainment licensed activity

Entrance/exit from the premises whilst regulated entertainment licensable activities are ongoing shall be via a lobbied door to minimise noise breakout.

The regulated entertainment licensable activity shall conclude 30 minutes before the premises is due to close to prevent excessive noise breakout as the premises empties

Other doors e.g. fire doors

The rear fire escapes (on ground and basement level) doors will be fitted with an alarm that instructs staff when the door has been opened

The rear fire escapes (on ground and basement level) doors will be fitted with an electronic device that cuts the power to the stage/performers area when the window/door is opened

Structure borne noise

All speakers are mounted on anti-vibration mountings to prevent vibration transmission of sound energy to adjoining properties

Sound limits

The licensee shall ensure that no music played in the licensed premises is audible at or within the site boundary of any residential property

All regulated entertainment amplified activity will utilise the in-house amplification system, the maximum output of which is controlled by the duty manager

The level of amplified regulated entertainment shall be controlled by means of limiting device set at a level which upon request may be agreed with the licensing authority

Outside Areas

No music will be played in, or for the benefit of patrons in external areas of the premises

No form of loudspeaker or sound amplification equipment is to be sited on or near the exterior premises or in or near any foyer, doorway, window or opening to the premises

No customers allowed to use external areas of premises except those queuing to enter or those smoking at front of premises and emergency use of the rear fire exits.

Deliveries and collections.

Deliveries and collections associated with the premises will be arranged between the hours 0800 through to 1800 Mondays to Saturdays (Not on Sundays or Bank Holidays) so as to minimise the disturbance caused to the neighbours

Empty bottles and non-degradable refuse will remain in the premises at the end of trading hours and taken out to the refuse point at the start of the working day rather than at the end of trading when neighbours might be unduly disturbed

Plant and machinery

All plant and machinery is correctly maintained and regularly serviced to ensure that it is operating efficiently and with minimal disturbance to neighbours arising from noise

Dealing with complaints

Liaison meetings will be held where specifically requested by residents to enable neighbours to raise concerns about any aspect of the licensed activities

Patrons entering/exiting premises.

Where people queue to enter the premises a licensed door supervisor shall supervise and ensure the potential patrons behave in an acceptable manner

Signs should be displayed requesting patrons to respect the neighbours and behave in a courteous manner

Door supervisors : Required to prevent breach of the peace and to be on duty from 1900 hrs to close of premises on Fridays, Saturdays and Sundays.

When the premises turn out a licensed door supervisor shall supervise patrons and ensure the leave in a prompt and courteous manner, respecting the neighbours

A licensed door supervisor will be positioned on the exit door to ensure, as far as reasonably practical, that patrons do not leave with drinks

Prevention of Nuisance from Odour

All ventilation and extraction systems shall be correctly maintained and regularly serviced to ensure that it is operating efficiently and with minimal disturbance to neighbours arising from odour

Prevention of nuisance from light

Illuminated external signage shall be switched off when the premises is closed

Security lights will be positioned to minimise light intrusion to nearby residential premises

Olson Kendra

From: Arben Neza [thebluebar675@gmail.com]
Sent: 26 February 2011 18:16
To: Olson Kendra
Subject: Re: Representations from Responsible Authorities on the Blue Bar

Hi Kera

Regarding the representation from the Noise Team I totally agree with them and looking forwards to change the reputation of the bar in the area. However me and my team will work hard to regulate the noise standards and fix it in the proper way that the locals would like it and even use the facility for their own time.

For any other information please contact me.

Many thanks

Arben Neza

The Blue Bar 675 High Road London N17 8AD

On Fri, Feb 25, 2011 at 4:16 PM, Olson Kendra <Kendra.Olson@haringey.gov.uk> wrote:

I have passed your e-mail on to the police and added it to your file. Please note that we still await your response to the representation from the Noise Team.

Regards,

Kendra Olson

Licensing Administrator

Haringey Council

Tel: 020 8489 5544

E-mail: kendra.olson@haringey.gov.uk

From: Arben Neza [mailto:thebluebar675@gmail.com]
Sent: 25 February 2011 14:42

APPENDIX 4

COMMENTS FROM PLANNING

Olson Kendra

From: Joyce Myles
Sent: 26 February 2011 11:45
To: Barrett Daliah
Subject: FW: Application for a New Premises Licence for THE BLUE BAR, 675 HIGH ROAD, TOTTENHAM, LONDON N17 8AD
Importance: High
Attachments: The Blue Bar 2010.pdf; THE BLUE BAR restarted.doc

Daliah

I do not think there is planning permission for these hours.

Myles Joyce
Team Leader
Planning Enforcement
Tel: 0208 489 5102
Fax: 0208 489 5220



From: Tailor Rajesh **On Behalf Of** Planning Enforcement
Sent: 24 February 2011 15:07
To: Joyce Myles
Subject: FW: Application for a New Premises Licence for THE BLUE BAR, 675 HIGH ROAD, TOTTENHAM, LONDON N17 8AD
Importance: High

Hi Myles

This was Michael's area

For your attention

Rajesh Tailor
Technical Support Officer | Enforcement | Urban Environment | Haringey Council
☎ 020 8489 5227
✉ rajesh.tailor@haringey.gov.uk
📍 Units 271-272 | Lee Valley Technopark | Ashley Road | London | N17 9LN



From: Olson Kendra
Sent: 23 February 2011 16:45
To: Food Haringey; Osinaike Charley; 'Christopher.Thorpe@met.pnn.police.uk'; 'firesafetyregulationNW@london-fire.gov.uk'; Planning Enforcement; Building Control; Boeuf Paul; Enforcement Response
Cc: Smith Paul; Cheshire Rebecca; Barrett Daliah; Anderson Chanel; 'Geoff.C.Parker@met.pnn.police.uk'

28/02/2011

This page is intentionally left blank

APPENDIX 5

REPRESENTATIONS OF INTERESTED
PARTIES

Olson Kendra

From: ashleigh trezise [ashleightrezise@yahoo.co.uk]
Sent: 21 March 2011 15:22
To: Barrett Daliah
Subject: Representation against the licence application for the BLUE BAR, 675 Tottenham High Road. N17 8AD

I am writing to make a representation against the licence application and reopening of the;

BLUE BAR, 675 Tottenham High Road. N17 8AD

Please read the reasons why the above mentioned application must be rejected.

TRACK RECORD

- The former/current owner and applicant of the Bar Mr Neza is ultimately to blame for the serious problems we have had to endure in the past couple of years for which he took no responsibility.
- To permit him to begin this cycle of disruption as the venue carries with it a lengthy track record of association that proves it should be closed down for the benefit of the wider community.
- As the ownership of the venue has not changed hands and I strongly believe this is another reason the club should never reopen after clearly seeing the carnage and utter disregard their customers have had for the last two years.

PUBLIC SAFETY

- The level and frequency of violence was unprecedented, was witnessed regularly and captured on CCTV with emergency vehicles attending to the aftermath of large scale fighting on the streets.
- The Blue Bar drains valuable public resources as the emergency services are constantly attending disturbances week in week out.
- The fighting would resume in adjacent streets as venue security could not intervene off site.
- Customers will be driving visibly drunk causing a threat to **public safety**.
- I believe that the permission for this club to operate on the same basis and by the same occupants regardless of new restrictions will not change the conduct of the customers once they have left the venue.
- The level of violent provocation and subsequent fighting by customers who drink alcohol irresponsibly will resume.
- The elderly people in our street are fearful and our local businesses feel threatened if they complain for fear of being targeted.
- I was directly was intimidated by an occupant of the premises when I stood and copied the address to submit an objection to the licensing panel.
- The dispersal zone order soon expires leaving the monitoring of a notorious drug and gambling hot spot open for the return of criminal activity.

NOISE DISTURBANCE

- Customers will park in adjacent streets and return to their cars shouting and slamming doors.
- Customers will urinate and throw glass beer bottles to smash on the road before driving off.
- We all have the right to an undisturbed sleep, to be free of fear, not to have the witness repeated violence in our residential roads.
- For some years now every Saturday and Sunday morning we would suffer from **noise disturbance** from Blue Bar customers shouting and urinating in the streets. As a professional who has to work through weekends, my sleep was disrupted every night.
- The noise at the rear of the venue via the service road will also cause direct noise pollution.

DISORDER

- Regular customers who have previous frequented the club will return and behave in a disorderly manner with total disregard for the local residents.
- I believe the staff of the venue will have no control over the level of noise disturbance and frequent outbreaks of violence once the customers leave the club.
- Our street will be left with the broken glass, litter, noise, displays of violence that violate our right to a decent quality of life.
- My family do not want this bar to have the opportunity to operate so close to a residential area with a track record such as theirs.

CHILD PROTECTION

- My son would be woken up and witness violence outside his bedroom window. He has suffered nightmares and the repeated experience has caused him great suffering and heightened anxiety.
- Children in our street will witness antisocial behaviour and become traumatised and extremely unsettled for a length of time to come this is a **violation of a child's right to feel safe** and that of **child protection**.

OPENING TIMES

- **We strongly object to the proposed opening hours** as they will cause significant noise disturbance in adjacent streets when customers leave the premises and return to their vehicles, throughout weekdays at 1am and after 5am on weekends causing major distress to residents.
- We believe an application that warrants any activity past 11pm to be **detrimental to the quality of the lives** of local residents and we object to these times.

PERSONAL STATEMENT

If this licence goes ahead to grant permission until 2017 it would mean the entire formative years of

my sons education and that of every child in the immediate vicinity will be marred by the disruption and lack of sleep. **Your decision will be sealing their fate and their future.**

My family have suffered because of this venue since we have lived here through lack of sleep. It is clear that it has caused stress, illness time off work and at times inability to manage my own affairs due to sheer exhaustion. .

Through consultation Residents of Ruskin Road and the surrounding area no longer want to witness or suffer the levels of disturbance and trauma to our children and elders caused by **excessive violence** and **antisocial behaviour**.

This **decision will impact ours and our children's lives as well as our entire community** who are already working tirelessly to improve our lives in an impoverished part of the borough.

To vote in favour of one businessman would have a devastating impact on our ability to create a healthy environment that enriches our children's lives and will demonstrate to the entire community that no one cares about the local people.

Since the previous license was revoked the entire area has been at peace and our children have managed to return to normal.

We ask that you close this venue for good. We request the usage of the premises be changed so that it cannot operate as a bar or club.

I would like to attend the hearing to put forward my objections in person.

I strongly object to this application.

Ashleigh Trezise

and

Paul Bruce
19 Ruskin Road
London N17 8ND

Please see enclosed representation against the licence application and reopening of the; BLUE BAR, 675 Tottenham High Road. N17 8AD

From

- **Residents of Ruskin Road**
- **Birkbeck Road**
- **Staff from Hillgreen Care Home**
- **Parent Governors from Lancastrian School**
- **Parent Teacher Association Members**



I wish to make a representation against the license application submitted by Mr Aben Neza for the Blue Bar 675 Tottenham High Road. N17.

As local residents in the Northumberland Park Area;

I object to the proposed opening hours as they will cause a noise disturbance in adjacent streets when customers leave the premises and return to their vehicles throughout weekdays at 1am and after 5am on weekends causing major distress to residents.

I object to the opening times and believe them to be detrimental to the quality of the lives of local residents and we object to these times and object the license application being granted to the Blue Bar.

I believe the regular customers who previous frequented the club will return and will behave in a disorderly manner with total disregard for the local residents.

I believe serious driving offences will be committed as customers consume alcohol and drive causing a threat to public safety.

I believe the staff of the venue will have no control over the level of noise disturbance and frequent outbreaks of violence once the customers leave the club and the enforced restrictions will not curtail this disturbance caused by customers in residential areas around the club.

I believe that the permission for this club to operate by the same owner regardless of new restrictions or previous licensees that he has nominated will not change the conduct of the customers once they have left the venue or the level of violent provocation and subsequent fighting caused by customers who drink alcohol irresponsibly.

I believe the broken glass, litter, noise and displays of violence to violate our right to a decent quality of life and a threat to public safety of local people.

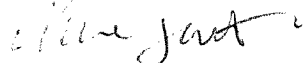
Signed 

Name NINA JATTA

Address 72 BIRUBELV RD N17 8NG.

I wish to make a representation against the license application submitted by Mr Aben Neza for the Blue Bar 675 Tottenham High Road. N17.

As local residents in the Northumberland Park Area;

I object to the proposed opening hours as they will cause a noise disturbance in adjacent streets when customers leave the premises and return to their vehicles throughout weekdays at 1am and after 5am on weekends causing major distress to residents.

I object to the opening times and believe them to be detrimental to the quality of the lives of local residents and we object to these times and object the license application being granted to the Blue Bar.

I believe the regular customers who previous frequented the club will return and will behave in a disorderly manner with total disregard for the local residents.

I believe serious driving offences will be committed as customers consume alcohol and drive causing a threat to public safety.

I believe the staff of the venue will have no control over the level of noise disturbance and frequent outbreaks of violence once the customers leave the club and the enforced restrictions will not curtail this disturbance caused by customers in residential areas around the club.

I believe that the permission for this club to operate by the same owner regardless of new restrictions or previous licensees that he has nominated will not change the conduct of the customers once they have left the venue or the level of violent provocation and subsequent fighting caused by customers who drink alcohol irresponsibly.

I believe the broken glass, litter, noise and displays of violence to violate our right to a decent quality of life and a threat to public safety of local people.

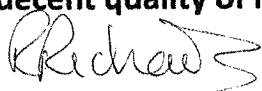
Signed 

Name

Address 69 Bubbbeck Rd
N17

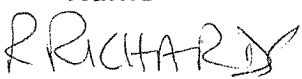
+ HH. Richards

I wish to make a representation against the license application submitted by Mr Aben Neza for the Blue Bar 675 Tottenham High Road. N17.

As local residents in the Northumberland Park Area;

I object to the proposed opening hours as they will cause a noise disturbance in adjacent streets when customers leave the premises and return to their vehicles throughout weekdays at 1am and after 5am on weekends causing major distress to residents.

I object to the opening times and believe them to be detrimental to the quality of the lives of local residents and we object to these times and object the license application being granted to the Blue Bar.

I believe the regular customers who previous frequented the club will return and will behave in a disorderly manner with total disregard for the local residents.

I believe serious driving offences will be committed as customers consume alcohol and drive causing a threat to public safety.

I believe the staff of the venue will have no control over the level of noise disturbance and frequent outbreaks of violence once the customers leave the club and the enforced restrictions will not curtail this disturbance caused by customers in residential areas around the club.

I believe that the permission for this club to operate by the same owner regardless of new restrictions or previous licensees that he has nominated will not change the conduct of the customers once they have left the venue or the level of violent provocation and subsequent fighting caused by customers who drink alcohol irresponsibly.

I believe the broken glass, litter, noise and displays of violence to violate our right to a decent quality of life and a threat to public safety of local people.

Signed

[Handwritten signature]
[Handwritten address]
N17 8NF

Name

[Handwritten name: WINSTON MURPHY]

I wish to make a representation against the license application submitted by Mr Aben Neza for the Blue Bar 675 Tottenham High Road. N17.

As local residents in the Northumberland Park Area;

I object to the proposed opening hours as they will cause a noise disturbance in adjacent streets when customers leave the premises and return to their vehicles throughout weekdays at 1am and after 5am on weekends causing major distress to residents.

I object to the opening times and believe them to be detrimental to the quality of the lives of local residents and we object to these times and object the license application being granted to the Blue Bar.

I believe the regular customers who previous frequented the club will return and will behave in a disorderly manner with total disregard for the local residents.

I believe serious driving offences will be committed as customers consume alcohol and drive causing a threat to public safety.

I believe the staff of the venue will have no control over the level of noise disturbance and frequent outbreaks of violence once the customers leave the club and the enforced restrictions will not curtail this disturbance caused by customers in residential areas around the club.

I believe that the permission for this club to operate by the same owner regardless of new restrictions or previous licensees that he has nominated will not change the conduct of the customers once they have left the venue or the level of violent provocation and subsequent fighting caused by customers who drink alcohol irresponsibly.

I believe the broken glass, litter, noise and displays of violence to violate our right to a decent quality of life and a threat to public safety of local people.

Signed 

Name 

Address 74 Birkbeck N17 2NH

I wish to make a representation against the license application submitted by Mr Aben Neza for the Blue Bar 675 Tottenham High Road. N17.

As local residents in the Northumberland Park Area;

I object to the proposed opening hours as they will cause a noise disturbance in adjacent streets when customers leave the premises and return to their vehicles throughout weekdays at 1am and after 5am on weekends causing major distress to residents.

I object to the opening times and believe them to be detrimental to the quality of the lives of local residents and we object to these times and object the license application being granted to the Blue Bar.

I believe the regular customers who previous frequented the club will return and will behave in a disorderly manner with total disregard for the local residents.

I believe serious driving offences will be committed as customers consume alcohol and drive causing a threat to public safety.

I believe the staff of the venue will have no control over the level of noise disturbance and frequent outbreaks of violence once the customers leave the club and the enforced restrictions will not curtail this disturbance caused by customers in residential areas around the club.

I believe that the permission for this club to operate by the same owner regardless of new restrictions or previous licensees that he has nominated will not change the conduct of the customers once they have left the venue or the level of violent provocation and subsequent fighting caused by customers who drink alcohol irresponsibly.

I believe the broken glass, litter, noise and displays of violence to violate our right to a decent quality of life and a threat to public safety of local people.

Signed

M. Henry

Name

MURTLE
HENRY

Address

24 RUSKIN ROAD
N17 8ND

I wish to make a representation against the license application submitted by Mr Aben Neza for the Blue Bar 675 Tottenham High Road. N17.

As local residents in the Northumberland Park Area;

I object to the proposed opening hours as they will cause a noise disturbance in adjacent streets when customers leave the premises and return to their vehicles throughout weekdays at 1am and after 5am on weekends causing major distress to residents.

I object to the opening times and believe them to be detrimental to the quality of the lives of local residents and we object to these times and object the license application being granted to the Blue Bar.

I believe the regular customers who previous frequented the club will return and will behave in a disorderly manner with total disregard for the local residents.

I believe serious driving offences will be committed as customers consume alcohol and drive causing a threat to public safety.

I believe the staff of the venue will have no control over the level of noise disturbance and frequent outbreaks of violence once the customers leave the club and the enforced restrictions will not curtail this disturbance caused by customers in residential areas around the club.

I believe that the permission for this club to operate by the same owner regardless of new restrictions or previous licensees that he has nominated will not change the conduct of the customers once they have left the venue or the level of violent provocation and subsequent fighting caused by customers who drink alcohol irresponsibly.

I believe the broken glass, litter, noise and displays of violence to violate our right to a decent quality of life and a threat to public safety of local people.

Signed

Name

Address

V. Mantilano

*21 Ruskin Rd.
London N. 17 8 ND*

I wish to make a representation against the license application submitted by Mr Aben Neza for the Blue Bar 675 Tottenham High Road. N17.

As local residents in the Northumberland Park Area;

I object to the proposed opening hours as they will cause a noise disturbance in adjacent streets when customers leave the premises and return to their vehicles throughout weekdays at 1am and after 5am on weekends causing major distress to residents.

I object to the opening times and believe them to be detrimental to the quality of the lives of local residents and we object to these times and object the license application being granted to the Blue Bar.

I believe the regular customers who previous frequented the club will return and will behave in a disorderly manner with total disregard for the local residents.

I believe serious driving offences will be committed as customers consume alcohol and drive causing a threat to public safety.

I believe the staff of the venue will have no control over the level of noise disturbance and frequent outbreaks of violence once the customers leave the club and the enforced restrictions will not curtail this disturbance caused by customers in residential areas around the club.

I believe that the permission for this club to operate by the same owner regardless of new restrictions or previous licensees that he has nominated will not change the conduct of the customers once they have left the venue or the level of violent provocation and subsequent fighting caused by customers who drink alcohol irresponsibly.

I believe the broken glass, litter, noise and displays of violence to violate our right to a decent quality of life and a threat to public safety of local people.

Signed  **HILLGREEN CARE HOME** **Name** Ross Dady

Address 13 KUSKIN ROAD
Tottenham N17 8ND

I wish to make a representation against the license application submitted by Mr Aben Neza for the Blue Bar 675 Tottenham High Road. N17.

As local residents in the Northumberland Park Area;

I object to the proposed opening hours as they will cause a noise disturbance in adjacent streets when customers leave the premises and return to their vehicles throughout weekdays at 1am and after 5am on weekends causing major distress to residents.

I object to the opening times and believe them to be detrimental to the quality of the lives of local residents and we object to these times and object the license application being granted to the Blue Bar.

I believe the regular customers who previous frequented the club will return and will behave in a disorderly manner with total disregard for the local residents.

I believe serious driving offences will be committed as customers consume alcohol and drive causing a threat to public safety.

I believe the staff of the venue will have no control over the level of noise disturbance and frequent outbreaks of violence once the customers leave the club and the enforced restrictions will not curtail this disturbance caused by customers in residential areas around the club.

I believe that the permission for this club to operate by the same owner regardless of new restrictions or previous licensees that he has nominated will not change the conduct of the customers once they have left the venue or the level of violent provocation and subsequent fighting caused by customers who drink alcohol irresponsibly.

I believe the broken glass, litter, noise and displays of violence to violate our right to a decent quality of life and a threat to public safety of local people.

Signed *Sikutenwood P.T.A LANCASTARIAN* **Name**

Address *263 Maul Peasant Rd
N17 6MD*

I wish to make a representation against the license application submitted by Mr Aben Neza for the Blue Bar 675 Tottenham High Road. N17.

As local residents in the Northumberland Park Area;

I object to the proposed opening hours as they will cause a noise disturbance in adjacent streets when customers leave the premises and return to their vehicles throughout weekdays at 1am and after 5am on weekends causing major distress to residents.

I object to the opening times and believe them to be detrimental to the quality of the lives of local residents and we object to these times and object the license application being granted to the Blue Bar.

I believe the regular customers who previous frequented the club will return and will behave in a disorderly manner with total disregard for the local residents.

I believe serious driving offences will be committed as customers consume alcohol and drive causing a threat to public safety.

I believe the staff of the venue will have no control over the level of noise disturbance and frequent outbreaks of violence once the customers leave the club and the enforced restrictions will not curtail this disturbance caused by customers in residential areas around the club.

I believe that the permission for this club to operate by the same owner regardless of new restrictions or previous licensees that he has nominated will not change the conduct of the customers once they have left the venue or the level of violent provocation and subsequent fighting caused by customers who drink alcohol irresponsibly.

I believe the broken glass, litter, noise and displays of violence to violate our right to a decent quality of life and a threat to public safety of local people.

Signed *Z. Gayran* - PARENT GOVERNOR

Name *Zehra*

Address *24 Durban Rd
N17 Tottenham
London*

Gayran

I wish to make a representation against the license application submitted by Mr Aben Neza for the Blue Bar 675 Tottenham High Road. N17.

As local residents in the Northumberland Park Area;

I object to the proposed opening hours as they will cause a noise disturbance in adjacent streets when customers leave the premises and return to their vehicles throughout weekdays at 1am and after 5am on weekends causing major distress to residents.

I object to the opening times and believe them to be detrimental to the quality of the lives of local residents and we object to these times and object the license application being granted to the Blue Bar.

I believe the regular customers who previous frequented the club will return and will behave in a disorderly manner with total disregard for the local residents.

I believe serious driving offences will be committed as customers consume alcohol and drive causing a threat to public safety.

I believe the staff of the venue will have no control over the level of noise disturbance and frequent outbreaks of violence once the customers leave the club and the enforced restrictions will not curtail this disturbance caused by customers in residential areas around the club.

I believe that the permission for this club to operate by the same owner regardless of new restrictions or previous licensees that he has nominated will not change the conduct of the customers once they have left the venue or the level of violent provocation and subsequent fighting caused by customers who drink alcohol irresponsibly.

I believe the broken glass, litter, noise and displays of violence to violate our right to a decent quality of life and a threat to public safety of local people.

Signed Sacha Meaden PTA

Name SACHA MEADEN

Address 96 BROADWATER ROAD
N17 6ET

I wish to make a representation against the license application submitted by Mr Aben Neza for the Blue Bar 675 Tottenham High Road. N17.

As local residents in the Northumberland Park Area;

I object to the proposed opening hours as they will cause a noise disturbance in adjacent streets when customers leave the premises and return to their vehicles throughout weekdays at 1am and after 5am on weekends causing major distress to residents.

I object to the opening times and believe them to be detrimental to the quality of the lives of local residents and we object to these times and object the license application being granted to the Blue Bar.

I believe the regular customers who previous frequented the club will return and will behave in a disorderly manner with total disregard for the local residents.

I believe serious driving offences will be committed as customers consume alcohol and drive causing a threat to public safety.

I believe the staff of the venue will have no control over the level of noise disturbance and frequent outbreaks of violence once the customers leave the club and the enforced restrictions will not curtail this disturbance caused by customers in residential areas around the club.

I believe that the permission for this club to operate by the same owner regardless of new restrictions or previous licensees that he has nominated will not change the conduct of the customers once they have left the venue or the level of violent provocation and subsequent fighting caused by customers who drink alcohol irresponsibly.

I believe the broken glass, litter, noise and displays of violence to violate our right to a decent quality of life and a threat to public safety of local people.

Signed  (Newsagent)

Name 

Address 689 Huth Rd
N17 8AD

I am writing to make a representation against the licence application and reopening of the;

BLUE BAR, 675 Tottenham High Road. N17 8AD

Please read the reasons why the above mentioned application must be rejected.

TRACK RECORD

- The former/current owner and applicant of the Bar Mr Neza is ultimately to blame for the serious problems we have had to endure in the past couple of years for which he took no responsibility.
- To permit him to begin this cycle of disruption as the venue carries with it a lengthy track record of association that proves it should be closed down for the benefit of the wider community.
- As the ownership of the venue has not changed hands and I strongly believe this is another reason the club should never reopen after clearly seeing the carnage and utter disregard their customers have had for the last two years.

PUBLIC SAFETY

- The level and frequency of violence was unprecedented, was witnessed regularly and captured on CCTV with emergency vehicles attending to the aftermath of large scale fighting on the streets.
- The Blue Bar drains valuable public resources as the emergency services are constantly attending disturbances week in week out.
- The fighting would resume in adjacent streets as venue security could not intervene off site.
- Customers will be driving visibly drunk causing a threat to **public safety**.
- I believe that the permission for this club to operate on the same basis and by the same occupants regardless of new restrictions will not change the conduct of the customers once they have left the venue.
- The level of violent provocation and subsequent fighting by customers who drink alcohol irresponsibly will resume.
- The elderly people in our street are fearful and our local businesses feel threatened if they complain for fear of being targeted.
- I was directly was intimidated by an occupant of the premises when I stood and copied the address to submit an objection to the licensing panel.
- The dispersal zone order soon expires leaving the monitoring of a notorious drug and gambling hot spot open for the return of criminal activity.

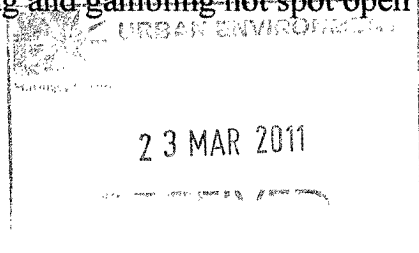

NOISE DISTURBANCE

- Customers will park in adjacent streets and return to their cars shouting and slamming doors.
- Customers will urinate and throw glass beer bottles to smash on the road before driving off.
- We all have the right to an undisturbed sleep, to be free of fear, not to have the witness repeated violence in our residential roads.
- For some years now every Saturday and Sunday morning we would suffer from **noise disturbance** from Blue Bar customers shouting and urinating in the streets. As a professional who has to work through weekends, my sleep was disrupted every night.
- The noise at the rear of the venue via the service road will also cause direct noise pollution.

DISORDER

- Regular customers who have previous frequented the club will return and behave in a disorderly manner with total disregard for the local residents.
- I believe the staff of the venue will have no control over the level of noise disturbance and frequent outbreaks of violence once the customers leave the club.
- Our street will be left with the broken glass, litter, noise, displays of violence that violate our right to a decent quality of life.
- My family do not want this bar to have the opportunity to operate so close to a residential area with a track record such as theirs.

CHILD PROTECTION

- My son would be woken up and witness violence outside his bedroom window. He has suffered nightmares and the repeated experience has caused him great suffering and heightened anxiety.
- Children in our street will witness antisocial behaviour and become traumatised and extremely unsettled for a length of time to come this is **a violation of a child's right to feel safe and that of child protection.**

OPENING TIMES

- **We strongly object to the proposed opening hours** as they will cause significant noise disturbance in adjacent streets when customers leave the premises and return to their vehicles, throughout weekdays at 1am and after 5am on weekends causing major distress to residents.
- We believe an application that warrants any activity past 11pm to **be detrimental to the quality of the lives** of local residents and we object to these times.

PERSONAL STATEMENT

If this licence goes ahead to grant permission until 2017 it would mean the entire formative years of my sons education and that of every child in the immediate vicinity will be marred by the disruption and lack of sleep. **Your decision will be sealing their fate and their future.**

My family have suffered because of this venue since we have lived here through lack of sleep. It is clear that it has caused stress, illness time off work and at times inability to manage my own affairs due to sheer exhaustion. .

Through consultation Residents of Ruskin Road and the surrounding area no longer want to witness or suffer the levels of disturbance and trauma to our children and elders caused by **excessive violence and antisocial behaviour.**

This decision will impact ours and our children's lives as well as our entire community who are already working tirelessly to improve our lives in an impoverished part of the borough.

To vote in favour of one businessman would have a devastating impact on our ability to create a healthy environment that enriches our children's lives and will demonstrate to the entire community that no one cares about the local people.

Since the previous license was revoked the entire area has been at peace and our children have managed to return to normal.

We ask that you close this venue for good. We request the usage of the premises be changed so that it cannot operate as a bar or club.

I would like to attend the hearing to put forward my objections in person.

I strongly object to this application.

Paul Bruce
19 Ruskin Road
London N17 8ND

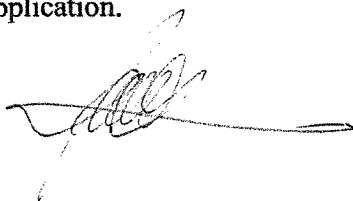

As local residents in the Northumberland Park Area and behalf of Ruskin Road I am writing to strongly object to the licence application and reopening of the **BLUE BAR, 675 Tottenham High Road**

The owner of the Bar Mr Neza is ultimately to blame for the serious problems we have had to endure in the past couple of years for which he took no responsibility. To permit him to begin this cycle of disruption will unravel all that our community is striving for. Is it not the **civic duty of officers** to respond positively to the residents and councillors that object to this application that, carries with it a lengthy track record of association that proves it should be closed down for the benefit of the wider community?

The level and frequency of violence was unprecedented, was witnessed regularly and captured on CCTV with emergency vehicles attending to the aftermath of large scale fighting on the streets. The injuries sustained were significantly brutal and the numbers of people participating in these mass brawls would reach up to 20-30 men and women alike.

For a decade I worked as a supervisor in many of the biggest clubs in London and never have I seen such devastation and destruction caused by members of a club. The Blue Bar drains valuable public resources as the emergency services are constantly attending disturbances week in week out. The fights would even resume after police had left.

We believe that the permission for this club to operate on the same basis and by the same occupants regardless of new restrictions will not change the conduct of the customers once they have left the venue or the level of violent provocation and subsequent fighting caused by customers who drink alcohol irresponsibly. The regular customers who previous frequented the club will return and will behave in a disorderly manner with total disregard for the local residents. They park in adjacent streets and return to their cars shouting and slamming doors. They proceed to drive cars after throwing their beer bottles to smash on the road before driving off visibly drunk and a threat to **public safety**. This is one reason why we want the application rejected.

As the ownership of the venue has not changed hands and we strongly believe this is another reason the club should never reopen after clearly seeing the carnage and utter disregard their customers have had for the last two years. As a professional who has to work through weekends, my sleep was disrupted every night. We all have the right to an undisturbed sleep, to be free of fear, not to have the witness repeated violence in our residential roads and to protect our children. Since the previous license was revoked the entire area has been at peace and our children have managed to return to normal.

23 MAR 2017

RECEIVED

I would like to attend the hearing to put forward my objections in person. I will also submit a written representation against. Please consider this information when making your decision and consider how **your decision will impact ours and our children's lives as well as our entire community** who are already working tirelessly to improve our lives in an impoverished part of the borough.

To vote in favour of one businessman would have a devastating impact on our ability to create a healthy environment that enriches our children's lives and will demonstrate to the entire community that no one cares about the local people.

We implore you to reject this application and not permit a club to reopen at this address.

Yours Sincerely

Ashleigh Trezise FRSA
19 Ruskin Road
London N17 8ND

A handwritten signature in black ink, appearing to read 'A. Trezise', written in a cursive style.

LICENSING ACT 2003 - REPRESENTATION FORM

To make a representation in respect of an application for a Premises Licence or Club Premises Certificate please complete the following form. For representations to be considered relevant they must relate to one or more of the four "Licensing Objectives" (listed below).

Please note all representations will be made available for applicants to view. If you make a representation objecting to the application it is likely that you will be called upon to attend a hearing and present your objection before a Licensing Committee.

<p>Personal Details</p> <p>Name.....SHEILA PEACOCK.....</p> <p>Address 62 HAMPDEN LANE.....TOTTENHAM.....</p> <p>Postcode.....N17 0AS.....</p>

<p>Licence application you wish to make a representation on</p> <p><i>You do not need to answer all of the questions in this section, but please give as much information as you can:</i></p> <p>Application Number.....</p> <p>Name of Licensee...ARBEN NEZA.....</p> <p>Name of Premises (if applicable).....THE BLUE BAR.....</p> <p>Premises Address (where the Licence will take t).....657 HIGH ROAD.....N17 8AD.....</p> <p>Postcode..... N17 8AD.....</p>
--

<p>Reason/s for representation</p> <p><i>Under the Licensing Act 2003, for a representation to be relevant it must be one that is about the likely effect of the application on the promotion of the four licensing objectives. Any representations that are considered to be vexatious or frivolous will not be considered (please see Haringey Council's leaflet Variations, Representations and Appeals for Premises Licences and Club Premises Certificates).</i></p> <p><i>Fill in reason/s for your representation in the space provided under each Licensing Objective it relates to</i></p>

<p>The Prevention of Crime and Disorder I HAVE HAD MANY COMPLAINTS ABOUT THIS PREMISES WHEN IT WAS LAST OPEN. The owner had no control over the people using the premises, they used to congregate around the back in an alley way drinking , swearing and making noise disturbing the residents in Ruskin Road. After the bar was shut people would leave in the early hours creating noise and on times fighting in the High Road to the distress of residents. When ever neighbours complained they were made to feel that they were being racist this was not the case as most of the residents in the area represent many cultures.</p>
<p>Public Safety After the bar was shut people would leave in the early hours creating noise and on times fighting in the High Road causing cars to swerve waking up residents in the near by flats. This was dangerous for drivers in their cars and people walking on the pavement. There was never any security overseeing the rear of the premises ensuing that peace and quiet took place.</p>
<p>The Prevention of Public Nuisance The owner did nothing to stop rowdy customers, in the past many times the windows of a nearby pub premises had their windows broken by fighting customers of the Blue Bar. People walking past the bar have been subjected to verbal abuse by drunken customers, who should not have been served once it was seen that they were already drunk, there seemed to be no control, thereby causing nuisance in the area.</p>
<p>The Protection of Children from Harm There are many flats in this area and children have been woken from their sleep by the noise and commotion, which was never controlled. Parents feared for their children having to be subjected to traumas when they should be having a good night sleep. This is not a suitable place for a Bar. If the licence is allowed then the times MUST be severely curtailed and certainly never after midnight.</p>

I, SARAH PEACOCK, hereby declare that all information I have submitted is true and correct.

Signed: S Peacock

Date: 23/3/11

Please send completed form to:

Haringey Council Licensing Team
Technopark
Ashley Road
Tottenham Hale
London

APPENDIX 6

RESPONSE FROM MR NEZA

Olson Kendra

From: Arben Neza [thebluebar675@gmail.com]
Sent: 23 March 2011 14:25
To: Olson Kendra
Subject: Re: FW: Representation against the licence application for the BLUE BAR, 675 Tottenham High Road. N17 8AD
Follow Up Flag: Follow up
Flag Status: Red
Attachments: Dear_Kendra[1].docx

Dear Kendra

I am attaching the response regarding the application.

For any further information please let me know.

Many thanks

Arben Neza

On Tue, Mar 22, 2011 at 12:07 PM, Olson Kendra <Kendra.Olson@haringey.gov.uk> wrote:

RE: APPLICATION FOR A PREMISES LICENCE FOR THE BLUE BAR, 675 HIGH ROAD, TOTTENHAM, LONDON N17 8AD REPRESENTATION RECEIVED

Please find below objection to the aforementioned application received today.

You will be advised of the date of the hearing.

If you have any queries please do not hesitate to contact me on the above details.

Yours sincerely,

Kendra Olson

Licensing Administrator

Haringey Council

23/03/2011

Dear Kendra,

Please treat this letter as a formal defence against the objection of Mrs. Ashleigh Trezise and Mr. Paul Bruce against the reopening of THE BLUE BAR 657, Highroad, Tottenham N178AD, dated 22 of March 2011, who described my management as irresponsible. Regarding their objection, I would like to provide few points to insure Mrs. Ashleigh Trezise and Mr. Paul Bruce that these kind of

incidents will never happened again.

Track Record

- As a lease holder, I legally subcontracted the business in good faith to one by one to two different managements with references, so I did not have any reason to presume that the premises would be misappropriated.
- Unfortunately, I did not have knowledge about the incidents in the bar and

serious problems and their impact on neighborhood.

- About the serious problems around the premises, I was informed in the end of the October 2010, when I called the Licensing department, after misleading information from my in that time tenants.

- In that time, tenants with their new business partner applied for new license, but after I was informed about the track record of the bar

and I asked Daliah Barret Administrator of Licensing department, Haringey Council, to withdraw their application form.

- I would like to point out regarding to the track record, when the Bar was directly under my management, there was no problem with customers, neighborhood or London Metropolitan Police.

Public Safety

- It is not my intention to serve customers who use

inappropriate behavior, but I would like to create a homely atmosphere for customers from all around the neighbourhood to enjoy their drink or cup of tea.

- The Blue Bar is not going to be used as club, and the late opening hours are asked just for occasional private parties of customers, who do not have bad manners and can conduct themselves in a decent manner.

- I did all needed steps to insure safety in and around the premises and regularly I have spoken to the members of Local Authorities and London Metropolitan Police.
- My CCTV system has all necessary standards and is approved by London Metropolitan Police and EU, plus has direct connection with my Iphone, so I will be informed about the situation in and around the bar constantly around the clock.

- I am a holder of an Alcohol license and SIA Card.

Noise Disturbance

- According to the track record of the bar under my direct management from January 2006 till late 2007 I never had any problems with the behavior of my customers, who were mainly from the professional background and I would like to keep it that way.

- I can insure you that my customers will not urinate around the premises and that the leaving the bar with any drink will not be allowed.
- I will take all needed steps to secure, that the service will not cause noise disturbance for neighborhood.
- We are going to have a same clientele us i had in my time when i was running the business under my management. The previous

customers will not be allowed any more in my premisses and are not my crowd and i believe from my experience that is the management who bring the crowd.

Disorder

- I will be in the bar every day and I will insure the level of noise and I will regulate behavior of the customers during the period when I was running the Bar by myself before.

- Glasses or bottles will never leave the premises with the customers.
- The bar has been refurbished to a high standards according to the aims of my loyal costumers.

Child Protection

- Safety of the children will be protected according to the statutory law of Great Britain and Northern Ireland.

Opening times

- It is not intention of The Blue Bar to be a club and the late opening hours are asked just occasionally for private parties and will cause no disturbance for the residents of the neighborhood.

Hoping that i will collaborate and have the good will of running the bar in the safer and pleasant environment from which would benefit the area. According to my previous good experience I

hope to have it in the future
and I promise also that things
like this will never happen
again.

For any further information i
am happy to discuss with the
authorities and the
neighbourhood.

Many thanks

Arben Neza

T/A The Blue Bar
675 High Road
London N17 8AD

Home address
319 Bowes Road
London N11 1BA

APPENDIX 7

COPY OF THE PREVIOUS LICENCE
WHICH WAS REVOKED

LICENSING ACT 2003
Sec 24

PREMISES LICENCE

Receipt: AG763207

Premises Licence Number: LN/000003162

This Premises Licence has been issued by:

**The Licensing Authority, London Borough of Haringey,
Technopark, Ashley Road, Tottenham, London N17 9LN**

Signature:.....

Date: 27th September 2007,
11th January 2010

Part 1 – PREMISES DETAILS

Postal Address of Premises or, if none, Ordnance Survey map reference or description:

**BLUE BAR
675 HIGH ROAD
TOTTENHAM
LONDON
N17 8AD**

Telephone: 020 8885 0500

Where the Licence is time limited, the dates:

N/A

Licensable activities authorised by the Licence:

Provision of Late Night Refreshment

Provision of Regulated Entertainment: live music, recorded music, performances of dance, provision of facilities for dancing

Supply of Alcohol

The times the Licence authorises the carrying out of licensable activities:

Provision of Late Night Refreshment

Monday, Tuesday & Thursday: 2300 to 0200

Wednesday & Sunday: 2300 to 0300

Friday & Saturday: 2300 to 0500

Provision of Regulated Entertainment:

Live Music:

Sunday & Wednesday: 2100 to 0230

Monday & Tuesday: 2100 to 0130

Thursday: 2100 to 0130

Friday & Saturday: 2100 to 0430

LICENSING ACT 2003

Sec 24

Recorded Music, Performances Of Dance, Provision Of Facilities For Dancing:

Monday Tuesday & Thursday: 0800 to 0130

Wednesday & Sunday: 0800 to 00230

Friday & Saturday: 0800 to 0430

The opening hours of the premises:

Monday, Tuesday & Thursday: 0800 to 0200

Wednesday & Sunday: 0800 to 0300

Friday & Saturday: 0800 to 0500

Where the Licence authorises supplies of alcohol whether these are on and/or off supplies:

Supply of alcohol for consumption **ON** the premises only.

Part 2

Name, (registered) address, telephone number and e-mail (where relevant) of holder of Premises Licence:

Mrs Kayowa Kabeya
13 Selborne Road
Wood Green
London
N22 7TL

Registered number of holder, for example company number, charity number (where applicable):

Name, address and telephone number of designated premises supervisor where the Premises Licence authorises the supply of alcohol:

Mrs Kayowa Kabeya
13 Selborne Road
Wood Green
London
N22 7TL

Personal Licence number and issuing authority of personal licence held by designated premises supervisor where the Premises Licence authorises for the supply of alcohol:

LN/000005087

Issued by: London Borough of Haringey

Expires: 06/02/2017

Annex 1 –Mandatory Conditions

(2) Supply of alcohol: No supply of alcohol may be made under the premises licence-

- (a) at a time when there is no designated premises supervisor in respect of the premises licence, or
- (b) at a time when the designated premises supervisor does not hold a personal licence or his personal licence is suspended.

(3) The second condition is that every supply of alcohol under the premises licence must be made or authorised by a person who holds a personal licence.

Door supervision

At specified times one or more individuals must be at the premises to carry out a security activity and each of these individuals must be licensed by the Security Industry Authority.

Annex 2 – Conditions consistent with the Operating Schedule

THE PREVENTION OF CRIME AND DISORDER

Premises to report any suspicious or illegal activities

Premises will have security employees who will man the doors and patrol the bar area.

The security team will check customers for drugs and weapons upon entering the premises and will not hesitate to call the relevant authorities.

The licensee will fix 6 CCTV cameras at the premises: 3 outside, 1 on the first floor and 2 on the ground floor.

The premises will be locked at night and closed.

Premises will have sufficient lighting inside and outside.

All excess stock and cash will be kept in the safe and premises will have 3 storages.

Policy is to be in place and posters will be in place at the premises to prevent alcohol and drug use.

Door supervisors will be used at all times when licensable activity is being carried out.

Persons suspected of carrying weaponry or illegal drugs will be searched and excluded from the premises.

An orderly queue will be maintained outside the venue.

Conditions as agreed with Metropolitan Police:

On Tottenham Hotspur Football Club Match Days:

1. Premises not to open for the sale of alcohol before 11.00 on Saturday and Sunday.
2. All drinks dispensed from the bar are poured into plastic containers—4 hours before the scheduled kick off time until 1 hour after the end of the match.
3. No glass bottles are sold over the bar—4 hours before the scheduled kick off time until 1 hour after the end of the match.
4. A minimum of two Door Staff who have been approved by the Security Industry Authority to be employed on the premises to control the entry and exit of customers—4 hours before the scheduled kick off time until 1 hour after the end of the match.

A digital CCTV is to be installed and made available to Police on demand. Copies are to be kept for 30 days.

PUBLIC SAFETY

Premises will adhere to all Health and Safety regulations

Fire exits will be checked on a regular basis.

Premises will have a full fire alarm and sprinkler system and illuminated exit signs.

There will be 4 fire extinguishers at the premises.

There will be a smoke detector, fire alarm, fire exit, heat detector and call point at the premises.

Premises will comply with all statutory fire and safety controls and will hold a fire certificate.

There will be a heat detector ventilation control and extractor fans will be in place.

All incidents will be reported.

Annex 2 – Conditions consistent with the Operating Schedule

Clear and visible notices will be displayed on the premises advising that CCTV has been installed and is being used on the premises.

THE PREVENTION OF PUBLIC NUISANCE

Premises will not serve those who are intoxicated.

A 30-minute "drinking up" time will be implemented.

Customers will be asked to leave the premises quietly and the relevant signage will be displayed.

The premises will not play any loud music which may cause nuisance to the public.

No activities will take place at the premises which may cause noises or sounds to emanate from the premises.

Rubbish bins and refuse will be kept at the rear of the premises.

Bins will be provided for customer use.

Doors and windows will be kept closed (except for access and egress) to reduce noise nuisance from the premises.

During final hour of opening the music will be played at a lower volume than previously.

Conditions agreed with The Noise Team:

Operating hours

That the premises closes no later than 02:00 on Monday, Tuesday and Thursday; that the premises closes no later than 03:00 on Wednesday and Sunday; and not later than 05:00 on Friday and Saturday.

That regulated entertainment ceases 30 minutes before closing times in order to minimise noise breakouts as the premises empties.

Prevention of nuisance from noise/vibration

All doors and windows will remain closed during the regulated entertainment licensed activities or in any event after 11pm. The entrance door will be fitted with a self-closing device and staff required to ensure that it is not propped open. A member of staff shall be made responsible to ensure the door is opened for as brief a period as possible. Where necessary adequate and suitable mechanical ventilation should be provided to public areas

Entry to the premises will be restricted to a particular entrance whilst the premises is being used for regulated entertainment licensed activity

Entrance/exit from the premises whilst regulated entertainment licensable activities are ongoing shall be via a lobbied door to minimise noise breakout.

The regulated entertainment licensable activity shall conclude 30 minutes before the premises is due to close to prevent excessive noise breakout as the premises empties

Annex 2 – Conditions consistent with the Operating Schedule

Structure borne noise

All speakers are mounted on anti-vibration mountings to prevent vibration transmission of sound energy to adjoining properties

Sound limits

The licensee shall ensure that no music played in the licensed premises is audible at or within the site boundary of any residential property

All regulated entertainment amplified activity will utilise the in-house amplification system, the maximum output of which is controlled by the duty manager

Outside Areas

No music will be played in, or for the benefit of patrons in external areas of the premises

No form of loudspeaker or sound amplification equipment is to be sited on or near the exterior premises or in or near any foyer, doorway, window or opening to the premises

Signs shall be displayed in the external areas/on the frontage requesting patrons to recognise the residential nature of the area and conduct their behaviour accordingly. The management must reserve the right to ask patrons to move inside the premises or leave if it is felt that they could be disturbing neighbours

The frontage will be closed and patrons requested to come inside the main structure of the premises at 23:00 hours

Deliveries and collections.

Deliveries and collections associated with the premises will be arranged between the hours 08:00 and 18:30, Mon- Sat, and none on Sundays and Bank Holidays so as to minimise the disturbance caused to the neighbours

Glasses will be collected at the beginning of the day rather than at closing time when neighbours in close proximity might be unduly disturbed

Empty bottles and non-degradable refuse will remain in the premises at the end of trading hours and taken out to the refuse point at the start of the working day rather than at the end of trading when neighbours might be unduly disturbed

Plant and machinery

All plant and machinery is correctly maintained and regularly serviced to ensure that it is operating efficiently and with minimal disturbance to neighbours arising from noise

Dealing with complaints

A complaints book will be held on the premises to record details of any complaints received from neighbours. The information is to include where disclosed, the complainants name, location, date time and subsequent remedial action undertaken. This record must be made available at all times for inspection by council officers

Annex 2 – Conditions consistent with the Operating Schedule

Regular state frequency liaison meetings will be held where requested to enable neighbours to raise concerns about any aspect of the licensed activities

Patrons entering/exiting premises.

Where people queue to enter the premises a licensed door supervisor shall supervise and ensure the potential patrons behave in an acceptable manner

Signs should be displayed requesting patrons to respect the neighbours and behave in a courteous manner

When the premises turn out a licensed door supervisor shall supervise patrons and ensure the leave in a prompt and courteous manner, respecting the neighbours

A licensed door supervisor will be positioned on the exit door to ensure, as far as reasonably practical, that patrons do not leave drinks in public areas.

A licensed door supervisor will patrol the cartilage of the premises to prevent patrons urinating in public areas in the vicinity of the premises

Prevention of nuisance from litter

Adequate receptacles for use by patrons will be provided in the local vicinity. The positioning of the receptacles will be agreed with the licensing officer

Prevention of Nuisance from Odour

All ventilation and extraction systems shall be correctly maintained and regularly serviced to ensure that it is operating efficiently and with minimal disturbance to neighbours arising from odour

Prevention of nuisance from light

Illuminated external signage shall be switched off when the premises is closed

Security lights will be positioned to minimise light intrusion to nearby residential premises

THE PROTECTION OF CHILDREN

Alcohol may only be sold to individuals over the age of 18 with valid proof of identification with one of the following:

- A valid passport
- A photo driving license issued in a European Union Country
- A proof of age standard card system
- A citizen card, supported by the Home Office

Unaccompanied children will not be allowed on the premises at any time.

The premises will only be open to adults.

Proof of identity will be checked when necessary.

Annex 3 – Conditions attached after a hearing by the licensing authority

Annex 4 - Plans

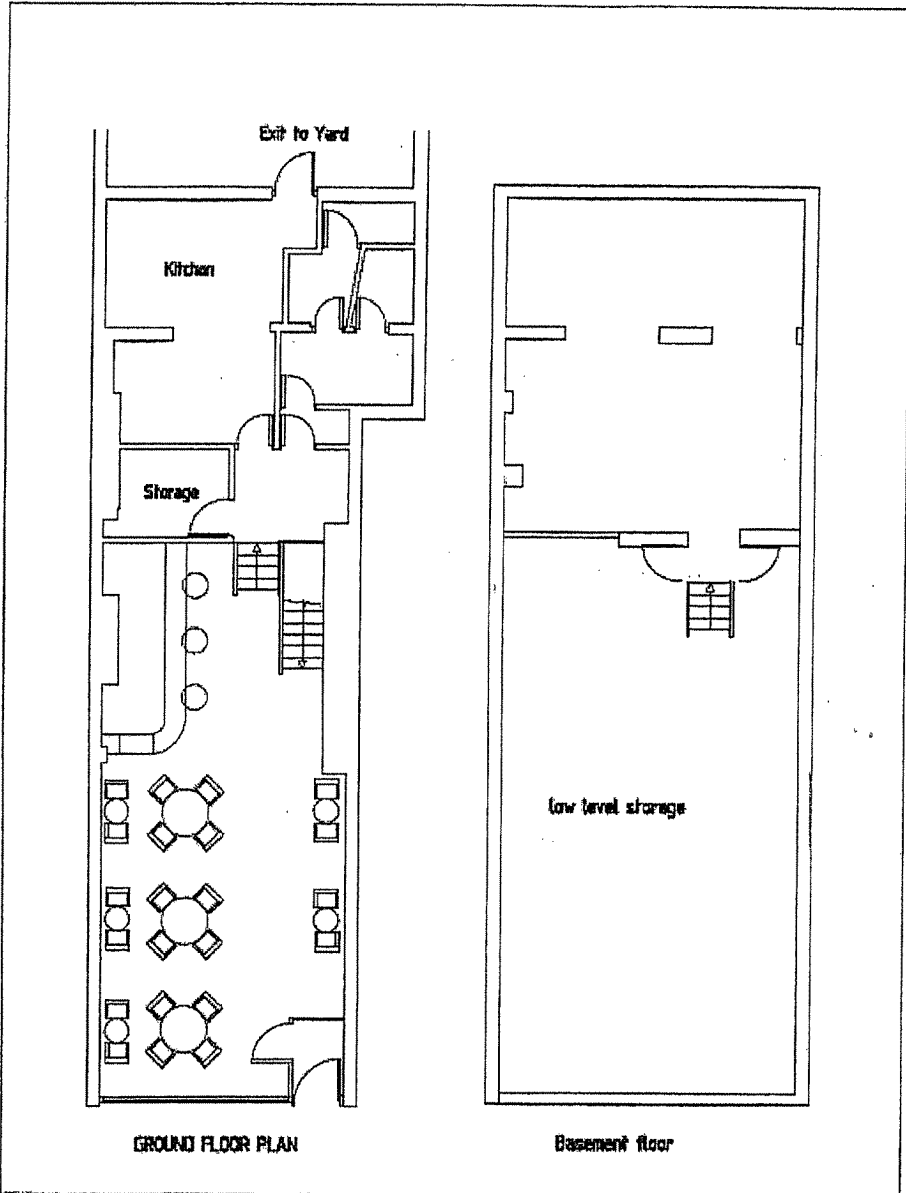

www.enki.co.uk

ENKI
Architectural Design
10% Cleveland Road, W19 7PP
Tel: 0181 808 4881
www.enki.co.uk

Project: 179 High road, Tottenham N19 8AD	Date: 07/10/2009	Drawn: GD	Scale: 1:100
Drawing Title: BASEMENT & GROUND FLOOR PLAN	Drawing no : OCT/001		